

St. Sebastian Parish  
**FOUNDATION**

**2025 ANNUAL REPORT**

# The Helen Hamlin Marshall Activity Center



As St. Sebastian Parish approaches its 100th anniversary in 2028, we are excited to announce plans for construction of the Helen Hamlin Marshall Activity Center. The new building will be named in honor of the late wife of Chester Marshall '66, who provided the lead gift for the project.

This new center will be an 8,300-square-foot multipurpose space, connected to the existing school building. It will feature a large, main activity room as well as three smaller meeting rooms. It will fill a critical need for meeting space in our active parish. On school days, the main activity space will be reserved for physical education classes and the school's after-care program, providing a more secure and dedicated space for these student activities. The project is expected to be completed in time for the parish's 100th anniversary celebrations in August of 2028.



In 2025, the St. Sebastian Parish Foundation launched the Centennial Capital Campaign to support this major project. By the end of 2025, the Foundation raised over \$3.1 million in cash and pledges toward this \$4 million project! The remaining funds to be raised will come from St. Sebastian parishioner donations made to the 2026 diocesan campaign. The portion returned to the parish will be restricted to this 100th anniversary project. If you have questions, please feel free to contact Kathy Holaday at [holadayk@stsebastian.org](mailto:holadayk@stsebastian.org) or 330-836-2233 x113.

## ACTIVITY CENTER FEATURES

### 1 Main Activity Room

This 4,650-square-foot room is large enough to meet the needs of physical education classes as well as school assemblies. It will provide a permanent location for the school's growing after-care program. The room can seat as many as 310 people for an event/meeting. This center will be reserved for use by our parish and school only. It will not be a rental facility and will not host CYO games or any other outside leagues/competitions. Byrider Hall will continue to be used for those events.

### 2 New Main Entrance

A new main entrance will be created that will serve as the entryway for both the new center and Zwislser Hall. After you enter, Zwislser Hall will be down the hall to the right, and the main activity room will be to the left.

### 3 Large Meeting Room: The Hanlon Family Meeting Room

At roughly 19 x 25, this 504-square-foot space can host meetings of up to 26 people comfortably.

### 4 Small Meeting Rooms: The Stiller Family Meeting Room & The Arrow Meeting Room

Two smaller rooms, roughly 12.5 x 16, are located just inside the doors of the new main entrance. Each room will accommodate 12 people, providing much-needed spaces for smaller groups and meetings.

### 5 History Hallway

The long hallway connecting the new activity center to Zwislser Hall will include a feature wall that will highlight the 100-year history and traditions of our parish and school.

### 6 Physical Education Office

The school's physical education teacher will have a dedicated office with adequate workspace located conveniently near both the main activity space and the Equipment Room.

### 7 Equipment Room

This large storage room will house equipment used for physical education classes.

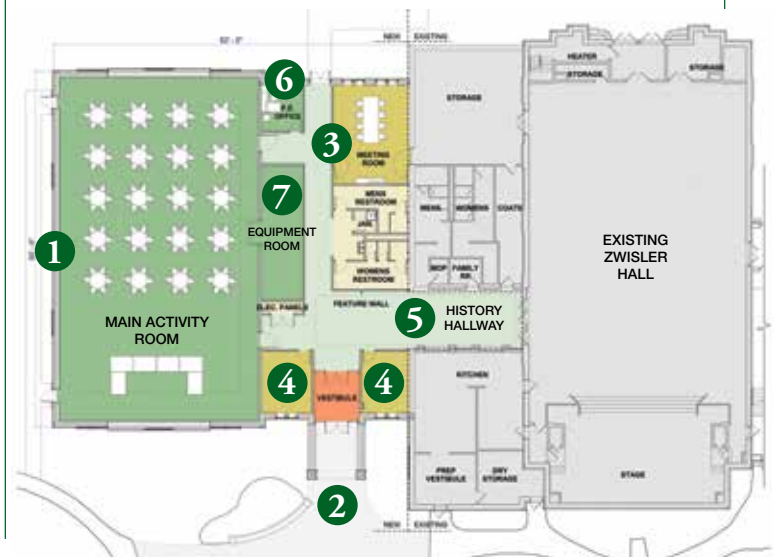

# FROM OUR PASTOR



Greetings,

Time is flying by as we approach the one hundredth anniversary of the founding of our parish. That means the oldest of our buildings are about a century old now. If we don't count the greenhouse, the "new church," which was consecrated in 1960, is now over 65 years old and is our newest building. But almost every day I hear about how wonderful our buildings and grounds are. In part, it is because those who came before us built well. But it is also because this community is willing to invest in itself.

Thanks to the St. Sebastian Parish Foundation and your generosity, we have been able to remain stronger than ever, even as older buildings mean more expense in keeping them up. And it is not only our buildings — our ministries and other projects are also able to function well and advance the mission of the Church because they are well supported. Our parish school and other educational initiatives, as well as sports, socials, special events, and even our worship activities are supported by our Foundation.

Soon we will be adding a new building to our campus, thanks in large part to the St. Sebastian Parish Foundation; the hard work of the Foundation's director, Kathy Holaday; the Foundation Board; and, of course, all of you who have been so generous and thoughtful in the support of your spiritual home. Please know of my gratitude and prayers. I know how fortunate I am to be at this parish and with all of you. Please keep our parish in your prayers.

As you continue reading through this report, I hope you are inspired by what this community has been able to accomplish. Know that the work is not done! We continue the work of developing the parish both spiritually and physically in order that we may hand on to the next generation a St. Sebastian Parish that is even better than what has been handed on to us.

Thank you and God bless,

A handwritten signature in black ink, with the initials "REV" circled in the beginning.

The Very Rev. John A. Valencheck  
Pastor, St. Sebastian Parish

---

**On the cover:** *The Padre Pio Chapel was dedicated and blessed on September 20, 2020, following renovations made possible by generous donations to the St. Sebastian Parish Foundation. This beautiful chapel serves as a place for prayer and reflection as well as an accessible confessional. Several large original paintings, which are displayed on the altar during portions of the liturgical calendar, reside in the chapel. The chapel also houses a cabinet for parish relics and treasures, including relics from St. Maria Goretti, St. John Newman, St. John Vianney, and Padre Pio. During the seasons of Lent and Easter, the parish relics are displayed in the Padre Pio Chapel. One set of the chapel's doors, pictured here, reflects the room's original role as the church's baptistry. Special thanks to parishioner Ed Balaun '76 who contributed these beautiful images of the Padre Pio chapel as well as several other photographs used in this report.*

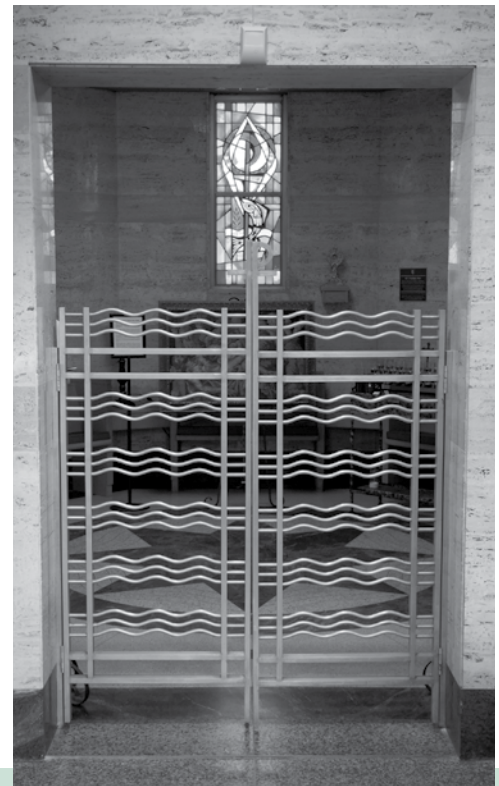

# FROM OUR PRESIDENT



Each year, I am reminded how fortunate and blessed we are to belong to a parish community that so faithfully lives its mission through generosity, service, and prayer. Our strength is found in our people: the role that each of you play ensures that our faith community remains vibrant and welcoming to all who visit and to all who call it home.

Throughout the past year, your gifts have supported scholarships, capital improvements, parish ministries, and the many programs that enrich the lives of our families and students. Each contribution, no matter the size, reflects a shared belief in the mission of St. Sebastian Parish and the importance of investing in the future.

One of our most exciting developments currently underway is the planned construction of The Helen Hamlin Marshall Activity Center. The activity center is named in honor of the late Helen Hamlin Marshall, wife of Chester Marshall (St. Sebastian Parish School, Class of 1966), whose generous donation was instrumental in the fundraising efforts of the Foundation. We are deeply grateful for this gift and for all the generous donors who are making this dream a reality. This will be a transformational project that will expand educational, athletic, and gathering spaces for our parish and school community. When completed, the new facility will provide a dedicated physical education space, meeting rooms, and additional areas that will enhance safety and opportunity for our students while strengthening the role our campus plays as a center of faith and fellowship.

The Foundation's impact is possible because of the extraordinary dedication of our parish leadership from Fr. Valencheck, our board members and development staff. I would like to extend sincere thanks to each of them for the stewardship they provide throughout the year. Their commitment ensures that every gift entrusted to the Foundation is managed responsibly and directed to the long-term needs of the parish.

As we look to the future, we remain focused on building a lasting legacy, one that continues to support Catholic education, deepens engagement within our parish community, and preserves the spiritual and cultural traditions that make St. Sebastian Parish thrive and remain a faith-filled home for generations to come.

Thank you for your faith, your generosity, and your continued partnership in this important work. It is truly an honor to serve this community.

With gratitude,

A handwritten signature in cursive script that reads "Brenda Pier Beck".

Brenda Pier Beck  
President, St. Sebastian Parish Foundation

## 2025 St. Sebastian Parish Foundation Board

Brenda Pier Beck, *President*  
Ken Contrera, *Treasurer*  
The Very Rev. John A. Valencheck,  
*Secretary*

Tim Beringer  
Tim DelMedico  
Lois Gerstenmaier  
Earl Hamlin

Amanda Leffler  
Patrick O'Neill  
Sophia Veillette  
Steve Wilt

# FINANCIAL STATEMENTS

St. Sebastian Parish Foundation Statement of Financial Position at December 31, 2024 and 2025. Contributions to the church and school from the Foundation from 1971 through 2025 total \$13,254,902.

ASSETS	2024	2025
Cash & Short Term Investments	\$ 419,439	\$ 556,248
Long-term Investments at Market:		
Fixed Income	\$ 2,759,134	\$ 3,052,274
Equities	\$ 4,228,149	\$ 5,912,619
Total Assets	\$ 7,406,722	\$ 9,521,141

LIABILITIES AND FUND BALANCES	2024	2025
Fund Balance	\$ 7,406,722	\$ 9,521,141
Total Liabilities and Fund Balances	\$ 7,406,722	\$ 9,521,141

St. Sebastian Parish Foundation Statement of Income and Expenses for the 12 Months Ending December 31, 2024 and 2025.

INCOME	2024	2025
Gifts & Fundraisers	\$ 854,765	\$ 1,808,950
Net Gains/Losses from Investments	\$ 515,455	\$ 967,610
Total Gifts and Gains	\$ 1,370,220	\$ 2,776,560

DISTRIBUTIONS AND EXPENSES	2024	2025
Distributions to Church and School	\$ 353,899	\$ 348,816
Expenses	\$ 305,393	\$ 343,785
Total Distributions and Expenses	\$ 659,292	\$ 692,601

The Foundation value over the last four years.

## Total Market Value

2025	\$9,521,141
2024	\$7,406,722
2023	\$6,695,787
2022	\$5,789,673

## Unrestricted Value

2025	\$3,320,313
2024	\$3,009,387
2023	\$2,676,693
2022	\$2,341,030

## Restricted Value

2025	\$6,200,828
2024	\$4,397,335
2023	\$4,019,094
2022	\$3,448,642

## Greenhouse Open House

On a sunny day in May, the Foundation hosted a Greenhouse Open House for our parish to come visit and celebrate the beautiful finished project. The Foundation raised money for the Greenhouse Fund in 2023, construction was largely completed in 2024, and the final touches of landscaping and lighting were completed in the spring of 2025 – when the Foundation was thrilled to host the open house and treat our faith community to 20 dozen donuts and 10 dozen cookies with special Greenhouse decorations!



Special thanks to Ryan Breiding '00 (parishioner, alumnus, and current school parent) of R.P. Breiding Landscape Design, who contributed the beautiful landscaping for our new Greenhouse in time for the open house on May 25, 2025.

# FROM OUR DIRECTOR

Greetings to our Parishioners, Alumni, School Families and Friends!

For nearly ten years, I have written letters for the annual report that are always longer than I had in mind. I really thought that at least one of my letters would be short and sweet! But, because we have such a vibrant parish, and because our Foundation always stands ready to assist our parish, this is another year with plenty to include in my letter!

This year, we added three new scholarships: The Chesterton Academy of Akron Wonder Scholarship, The Doucet Family Scholarship, and The Stephen & Generose Marks Memorial Scholarship. The Foundation now manages nearly 90 endowments, funds, and scholarships (see page 5). I am pleased to report that the Foundation has steadily increased the number of scholarship awards and the dollar amounts awarded to our students each year. Please see page 12 to learn more.

Many projects, repairs, and general campus improvements occurred in 2025. The "Creating Welcoming Spaces" project included notable updates to the Quiet Room, the Bride's Room, and even the church basement! Please see pages 16-17 for details and to see pictures of this project as well as the several other capital projects supported by the Foundation in 2025.

And last but certainly not least, in 2025 the Foundation launched the Centennial Capital Campaign to support a major project to celebrate the parish's 100th anniversary: the construction of a \$4 million activity center. **By the close of 2025, the Foundation raised over \$3.1 million in donations and pledges for this project.**

## 2025 St. Sebastian Parish Foundation Development Office

Kathleen Holaday, *Director of Development*

Anne Dennée, *Development Assistant*

Ron Klamert, *Development Assistant*



The Helen Hamlin Marshall Activity Center is scheduled to be completed in August 2028, with the grand opening anticipated to be just in time for the parish's 100th anniversary celebrations! Please see the inside front cover to learn more and to see renderings of the new center. If you are interested in supporting the project, I hope you will give me a call.

I am filled with gratitude and appreciation for the many parishioners, alumni, and friends who continue to donate to the Foundation, both those who are new donors and those who have been so dedicated over the years. These generous donors have supported our parish in so many areas, helping preserve the traditions of St. Sebastian Parish and allowing these traditions to be treasured and celebrated for nearly 100 years. Thank you.

Sincerely,

A handwritten signature in cursive script that reads "Kathleen Zehenni Holaday".

Kathleen Zehenni Holaday  
Director of Development  
St. Sebastian Parish Foundation



Our beautiful baptismal font, which was originally located in what is now the Padre Pio Chapel, now resides in the front of the church near the statue of St. Joseph.

# FUNDS AND ENDOWMENTS

The St. Sebastian Parish Foundation oversees nearly 90 named funds, endowments, and scholarships. If you would like to support any of the endowments or funds listed on this page, please feel free to use the enclosed envelope. If you would like to start your own named fund or endowment with the St. Sebastian Parish Foundation, we can help! Starting an endowment or fund is a great way to help secure the financial future of the parish. For more information, please contact Kathy Holaday (330-836-2233 x113 or holadayk@stsebastian.org) or go to [stsebastian.org/foundation/funds-and-endowments](http://stsebastian.org/foundation/funds-and-endowments).

## Foundation Funds and Endowments

### Unrestricted Fund

Unrestricted Gifts for the Greatest Needs of the Parish

## Church Funds and Endowments

### Adult Education

Foley Family Adult Religious Education Endowment  
Fr. William D. Karg Faith Formation Fund

### Bereavement

Paul A. and Patricia A. Hummel  
Bereavement Endowment

### Capital

Adoration Chapel Fund  
Byrider Hall Improvement Fund  
Church Improvement Fund  
Greenhouse Fund  
Helen Hamlin Marshall Activity Center Fund (**new**)  
John L. and Nellie A. Tormey Rectory  
Restoration Fund

### Clergy

Fickes Family Clergy Enrichment Endowment  
Seminarian Scholarship Fund  
Vocational Health and Wellness Fund

### Education

The Academy of Culture and Arts Fund

### Grounds

Grounds Crew Flower Fund  
Zwister Hall Plaza Grounds Fund

### Music

Music Endowment  
Organ Fund

### Other

Boy Scout Troop #96 Fund  
Knights of Columbus Council #14255  
Deacon Terry Peacock Memorial  
Scholarship Fund  
Natural Family Planning (NFP) Fund  
Catherine Paparella Memorial Fund  
Sanctuary Society Fund  
Marcy Smith Rectory Kitchen Fund  
St. Gabriel Fund  
Votive Candle Fund

## School Funds and Endowments

### Athletics

Athletic Booster Club Fund

### Capital

St. Sebastian School Fund

### Education

Victor E. Buehrle, Jr. Science Lab Fund  
Helen Barry Hamlin Library Fund  
Mary Jane Hudak Roberts Math Endowment  
Spectacular Arts and Cultural Enrichment Fund  
Spectacular Garden Fund  
Spectacular General Fund  
James R. and Marie T. White  
School Library Endowment

### Tuition Assistance

Alumni Scholarship Endowment  
Frances and Bernard Amer Family  
Scholarship Endowment  
The Thomas and Marjorie Burkley  
Memorial Fund  
Fr. Charles Byrider Education Endowment  
Hugh Colopy Scholarship Endowment  
Comunale, Meyo, Clarke Scholarship  
Endowment  
Dayspring Tuition Grant Fund  
Deacon Terry Parish School Endowment  
Franklin K. and Delores H. Dietzler  
Education Endowment  
Alberta Hensley Scholarship Endowment  
Hank and Eileen Hudson Scholarship  
Endowment  
John and Joan Kelley Scholarship Endowment  
Mr. and Mrs. James M. Lyons, Sr.  
Family Endowment  
M.G. O'Neil Scholarship Endowment  
Wm. J. O'Neil Scholarship Endowment  
Lewis and Kathleen Seikel Scholarship  
Endowment  
Sheeks Family Scholarship Endowment  
Stiller Family Scholarship Endowment  
Jay and Marilyn Stitz Scholarship Endowment  
Terrier Family Scholarship Fund  
Victor and Maralyn Yanko Family Scholarship  
Endowment

### Tuition Assistance and Teacher/Staff Support

Dr. H. Thomas and Mary Rita Baumgardner  
Scholarship Endowment  
Cleary Family Scholarship Endowment  
Eugene D. and Marie T. Graham Scholarship  
Endowment  
Dr. Carl E. Krill, Sr. Family Endowment  
McFarland Education Scholarship Endowment  
Esther Simonetti Owen Scholarship Endowment  
James M. Pier, Sr. Scholarship Endowment  
William and Mildred Walzer Education Endowment  
Richard and Carroll Weber Scholarship Endowment

### Teacher/Staff Support

Louis H. Amer Education Endowment  
Christopher James Consilio Student  
Enrichment Award  
Mary Jo Costigan Teacher's Salary Endowment  
James E. and Yvonne Dietrich Family Endowment  
Social Ministry Fund  
St. Sebastian School Employee Spectacular Fund

### Scholarships

Michael R. Beck III Memorial Scholarship Fund  
Mary Ley Burke and Thomas Edward Burke  
Memorial Scholarship Endowment  
Chesterton Academy of Akron Wonder  
Scholarship Fund (**new**)  
Christopher James Consilio Memorial  
Scholarship Fund  
Dayspring Opportunity Scholarship Endowment  
Doucet Family Scholarship Endowment (**new**)  
Elms Family Scholarship Fund  
Denise Maroon Finley Memorial Scholarship Fund  
Lynn Frey-Steward Organ Scholarship Fund  
Gerstenmaier Family Scholarship Endowment  
GOAL Scholarship Endowment  
(Graves O'Neill Academic Leaders)  
Hanlon Family Scholarship Endowment  
Karg Family Scholarship Endowment  
Tom and Jeanne LaRose Family Memorial  
Scholarship Endowment  
William and Mildred Loftus Memorial  
Scholarship Fund  
Stephen & Generose Marks Memorial Scholarship  
Fund (**new**)  
Frances L. Sharp Music Scholarship Endowment  
John A. Trecaso Scholarship Fund

# THANK YOU

to everyone who donated to the St. Sebastian Parish Foundation in 2025!

The Foundation is deeply thankful for the steadfast support of the St. Sebastian Parish community. Your donations in 2025 helped provide crucial annual support for our church and school through unrestricted donations, which are directed to the areas of greatest need, as well as restricted donations, which are designated for specific ministries, needs, and projects.

Listed below are the individuals and organizations who made a gift to the Foundation during the 2025 calendar year (Jan. 1, 2025 - Dec. 31, 2025). If we have incorrectly listed or inadvertently omitted your name, please contact the Foundation (330-836-2233 x113, foundation@stsebastian.org) so we may correct our records. Thank you for your generous support of the St. Sebastian Parish Foundation!

## RESTRICTED GIFTS

### **Academy of Culture and Arts Fund**

Kaye Kipp Rowe

### **Adoration Chapel Fund**

Dennis and Charise Kasper  
Paul and Cathy Mungo  
James and Kathleen Smith

### **Alumni Scholarship Endowment**

Anne Lynett Clark  
Terence and Barbara Crawford  
Robert Floyd  
Greg Getzinger  
Dr. Joseph M. Khoury  
Kathy Kuzma  
Mike and Ginny McGuckin  
Richard McGuckin  
Thomas and Linda Riegler  
Kaye Kipp Rowe  
Mary and George Skalkos  
Laura Tornichio

### **Dr. H. Thomas and Mary Rita Baumgardner Scholarship**

Bill and Kelly Baumgardner  
Ken and Peggy Contrera

### **Michael R. Beck III Memorial Scholarship Fund**

Milo and Mary Lou Chelovitz  
Patrick and Pamela O'Neill  
Jim Redmond

### **Boy Scout Troop 96 Fund**

John and Barbara Jost

### **Victor E. Buehrle, Jr. Science Lab Fund**

Kathleen J. Buehrle  
Lorena Floccari and Ross Schomberg  
Rosemary and Frank Floccari  
Jeannie and Jubi Hillery

### **The Mary Ley Burke and Thomas Edward Burke Memorial Scholarship Endowment**

Anonymous  
Ginny Bowers  
David and Teresa Burke  
Thomas\* and Laurie Burke  
Catherine Conway  
Charlie and Mary Crowley  
Nancy and Ben Harmon  
Brian and Jeanne Heard  
Richard and Glenda Heard  
Ann Huesken  
Rich and Mary Ellen Crowley Huesken  
William Huesken and Kaylee Charlton

Sally Jochimsen  
Mary Lee Mattis  
Jane May  
Corinne Reeves  
Gus and Belinda Rubio

### **The Thomas and Marjorie Burkley Memorial Fund**

Paul and Cathy Mungo

### **Fr. Charles Byrider Education Endowment**

Christopher and Melissa Bauer  
Andrew Bebesi  
The Ralph L. & Florence A. Bernard Foundation Trust  
Mr. and Mrs. John Blike, Jr.  
Ken and Peggy Contrera  
Terence and Barbara Crawford  
Bernadette M. Dierker  
David and Patricia Fitzgibbons  
Frederick George  
Lois and John Gerstenmaier  
Louise J. Hughes  
Mr. and Mrs. Robert Kraus, Jr.  
David and Kristina Newyear  
John and Kathleen O'Brien  
Robin and Marian Olsen  
Steve and Barbara Panzner  
Kathleen M. Seikel  
Marcy Smith  
Susan Teagarden  
Lou and Micki Trenta  
Charles and Janice Von Spiegel

### **Chesterton Academy of Akron Wonder Scholarship Fund**

The Chesterton Academy of Akron

### **Church Improvement Fund**

Anonymous (2)  
Tom and Kathy Dietrich  
Laura Powers  
Laura Stallings  
John and Colleen Zografakis

### **Cleary Family Scholarship Endowment**

Mr. and Mrs. Donald J. Cleary  
Thomas and Patricia Cleary  
Cathleen Cleary Hawes

### **Comunale, Clarke, Meyo Scholarship Endowment**

Frank C. Comunale  
Stephen A. Comunale

### **Christopher James Consilio Memorial Fund**

William Cotter  
Ms. Marjean M. Hull

### **Dayspring Opportunity Scholarship Fund**

Anonymous  
Linda Davis  
Dayspring Foundation

### **Dayspring Tuition Grant Fund**

Dayspring Foundation

### **Deacon Terry Parish School Endowment**

Frank C. Comunale  
John and Colleen Zografakis

### **Doucet Family Scholarship Endowment**

Brian and Jennifer Doucet

### **Denise Maroon Finley Memorial Scholarship Fund**

Chuck Maroon

**Lynn Frey-Steward Organ  
Scholarship Fund**  
Ken and Sally Stenger

**Gerstenmaier Family Scholarship  
Endowment**

Courtney Gerstenmaier Felton  
Lois and John Gerstenmaier  
Patrick and Pamela O'Neill

**Greenhouse Fund**

Anonymous (2)  
Milissa Smith  
Susan Teagarden

**Grounds Crew Flower Fund**

Dolores Lobello DiCresce  
Heather Kilpatrick  
Fred and Jeannie King  
Patricia Lobello-Lamb  
Anita Meeker

**Helen Barry Hamlin Library Fund**

Alan and Tari Abrams  
Michael Abrams  
The Tarang and Hirni Amin  
Family Fund  
Julia Bain\*  
Tom and Chris Baugh  
Brenda and Mike Beck  
Mark and Beverly Belgya  
Ann and John Beringer  
J. David Bourke  
John and Allison Brase  
Jeffrey Bresler  
The Broers, Browns and Lallathin  
Families  
Bob and Martha Burgoon  
Charles and Karen Hay Chadwick  
Mark and Cathy Clark  
Stephen A. Comunale  
James and Renee Conlon  
Richard and Anne Davidovich  
Julie Deane  
Timothy and Jennifer DelMedico  
William S. Eakins, Jr.  
Dr. and Mrs. Ernest Estep  
Ann and John Fairweather  
Richard and Colleen Farrell  
Randi Forrest  
Judith Fowler  
Ethel Seiberling Fox  
Michael Foy and the RBC Team  
Deborah Franz  
Ruthie George

# Planned Giving/Arrow Society

## Shaping a Legacy of Hope for St. Sebastian Parish

### PLANNED GIVING

You can shape a legacy of hope for future generations and ensure the integrity and impact of your family's charitable giving by creating a personalized Planned Gift through the St. Sebastian Parish Foundation. Planned Gifts are simply donations that will be received sometime in the future. Examples include designating the St. Sebastian Parish Foundation as a beneficiary of a will, trust, retirement plan, life insurance policy, bank account or stock holding. A Planned Gift to the Foundation is a wonderful final act of financial support and stewardship for your parish.

### ARROW SOCIETY CIRCLE

When you inform the St. Sebastian Parish Foundation that you have included (or intend to include) the Foundation in your estate plans, you will become a member of the Arrow Society Circle. The Foundation will keep this information on record so that your gift intent is documented.



### ARROW SOCIETY

When your estate gift is received by the St. Sebastian Parish Foundation, you will become a member of the Arrow Society. Your name will be added to our beautiful Arrow Society remembrance plaque that resides in the narthex of our church.



### NEW ARROW SOCIETY MEMBERS:

The St. Sebastian Parish Foundation is pleased to recognize the newest members of the Foundation's Arrow Society. Their bronze nameplates will be added to the plaque in the church narthex. Our sincerest appreciation is extended to these donors and all our Arrow Society donors and their families who remembered St. Sebastian Parish Foundation in their wills and estates. We are deeply thankful for these legacy donations, which support the parish as a place of hope and worship for future generations.

**Ramona Kormanik Botzum '42**

**Helen Hamlin Marshall**

To view a complete list of all the Arrow Society members listed on this plaque, please visit [stsebastian.org/foundation/arrow-society-members](http://stsebastian.org/foundation/arrow-society-members).

For more information on Planned Giving, Arrow Society, or Arrow Society Circle, please contact Kathy Holaday at the Foundation (330-836-2233 x113, [holadayk@stsebastian.org](mailto:holadayk@stsebastian.org)) or visit the Foundation's Planned Giving web page: [stsebastian.org/foundation/planned-giving](http://stsebastian.org/foundation/planned-giving).

**Helen Barry Hamlin Library Fund, cont'd**

The Patricia and J. Harvey Graves Family Foundation  
Robin Hardman  
Georgie Herro and Lamice Saidy  
Laura Hunsicker  
Joseph and Janis Hutchinson  
The J. M. Smucker Co.  
Patricia and Timothy Jolly  
Otto and Anne Kern  
Gail Kinzel  
Jim and Sally Klein  
Jeanette Knudsen  
Peggy Ethridge Koblenzer  
David and Nancy Koly  
Robert Krautsak  
Renee Kulman  
Tom and Meg Lamb

Barbara Carroll LaRose  
Michael and Debra Lavelle  
Donna Leahy  
Wilson and Wendy Lewis - Lewis Landscaping & Nursery Inc.  
Allen and Donna Loomis  
Mary and Jim Lyons  
Mr. and Mrs. Frederick May  
Brian and Stephanie McCarty  
Mr. and Mrs. Seward Prosser Mellon  
Steve and Laurice Moore  
John and Kathleen Negrelli  
Omar Nemer and Bahar Moftakhar  
Erik and Angela Niermeyer  
Robin and Marian Olsen  
The Preferred Legacy National Trust Bank

Joshua Rivard  
Anne Hardman Roddy  
Richard and Alita Rogers  
Molly and Dave Scantling  
Alan Scharfstein  
David Schrader  
Margot and Ron Schroder  
Jane P. Schwab  
Elizabeth Sheeler  
John Shulan  
Jillian Snoko  
Glen Stalcup, Jr.  
Jodi Taylor  
Margaret Taylor  
Judith Jones Thomas  
Ann Traverse  
Maureen Van Duser  
Alexandra Walker  
Robert and Fleur Warther  
William and Kathryn Welsh  
Mark and Colleen Wernig  
Pamela and Frank\* Wharton  
Ed and Mandy Williams  
Bradley Wojno  
Mary Wojno  
Christine Yuhasz

**William and Mildred Loftus Memorial Scholarship Fund**

Ann Loftus  
Mary\* Loftus

**Mr. and Mrs. James M. Lyons, Sr. Family Endowment**

Mary and Jim Lyons

**Stephen & Generose Marks Memorial Scholarship Fund**

Anonymous  
Frank C. Comunale  
Tricia Marks Marshel  
Mary Cay and Tom Pelot  
Michael N. Rabe Family Philanthropic Fund  
Heather and Barry Thoman

**Helen Hamlin Marshall Activity Center Fund**

Mark and Becky Adamczyk  
John and Karen Bader Family Fund  
Tom and Chris Baugh  
Mike and Brenda Beck  
Jim and Rosanne Burns  
Ken and Peggy Contrera  
The Honorable Deborah Cook  
Jim and Peggy Costigan  
Timothy and Jennifer DelMedico  
Karen M. Frey  
Lois and John Gerstenmaier  
Earl W. Hamlin III  
Heidi and Matthew Heinle  
Kathleen and Mark Holaday  
Nancy Mannion  
Chester Marshall  
Patrick and Pamela O'Neill  
William Stiller  
Sophie and Bob Veillette  
Gina and Thomas Walker  
Jim and Linda Wilkins  
Steve and Holly Wilt

# The Stephen & Generose Marks Memorial Scholarship Fund

Initiated in 2025, The Stephen & Generose Marks Memorial Scholarship Fund was established in honor of Steve and Generose by their daughters: Mary Cay, Jane, Carolyn, Ellen, Tricia, and Heather. Steve and Generose were active and dedicated parishioners and believed in the importance of Catholic education. The purpose of this fund is to provide scholarships to students of St. Sebastian Parish School who are parishioners. The scholarship is available for students entering kindergarten through 8th grade.



To learn more about donating to The Stephen & Generose Marks Memorial Scholarship Fund, please contact Kathy Holaday at the Foundation (330-836-2233 x113, holadayk@stsebastian.org) or visit the Foundation's Funds and Endowments web page: [stsebastian.org/foundation/funds-and-endowments](http://stsebastian.org/foundation/funds-and-endowments).

**Hanlon Family Scholarship Endowment**

Deidre A. Hanlon and Ronald E. George

**Hank and Eileen Hudson Scholarship Endowment**

Edward Jost  
John and Barbara Jost  
Mark and Margie Jost  
The Stephen and Carol Jost Charitable Fund

**Paul and Patricia Hummel Bereavement Endowment**

Caroline Hummel  
Paul and Jenny Hummel

**Karg Family Scholarship**

Tom and Katy Karg

**John and Joan Kelley Scholarship Endowment**

Jim and Joan Kelley  
Mary and Jim Lyons

**Dr. Carl E. Krill, Sr. Family Endowment**

Kevin and Mary Lynne Krill

**Music Endowment**

Ronald Scarpitti  
Ken and Sally Stenger  
David\* and Lois Weis

**Natural Family Planning Fund**

Paul and Cathy Mungo

**M.G. O'Neil Scholarship Endowment**

M.G. O'Neil Foundation

**Wm. J. O'Neil Scholarship Endowment**

Nancy Beringer

**Organ Fund**

Anonymous  
Kathleen Shisler  
Ken and Sally Stenger

**James M. Pier, Sr. Scholarship Endowment**

Brenda Pier Beck

**Sanctuary Society Fund**

Pamela Arman  
Paul and Cathy Mungo

**Seminarian Scholarship Fund**

Dennis and Charise Kasper  
Joan Kramer  
Sally Longville  
James and Rosemary Reed

**Frances L. Sharp Music Scholarship Endowment**

Frances Sharp  
Ken and Sally Stenger

**Sheeks Family Scholarship Endowment**

Donn I. Cramblette

**Marcy Smith Rectory Kitchen Fund**

Christine Boyce  
Kendra Jones  
Barbara Carroll LaRose  
Domenico and Diane Lazzarini  
Tracy and Jim Legner  
Jeff McElhinny  
Anne Miller  
Paul and Cathy Mungo  
Cristine Pace  
Sue and Bo Roberts  
Kristine and Stephen Rosenfeld  
Susan Teagarden  
Bill and Peggy Wellemeyer

**Social Ministry Fund, Ladies Luncheon & Christmas Boutique Sponsors**

Anonymous  
Megan Azar  
Brenda Pier Beck  
Emily Boarman  
Anita Calleri

Kelsey Casano  
Nicole Clymire  
Crafty Steere LLC  
Katie Danzy  
Flora N. Dees  
Emily Fernandez  
Erica Gerstenmaier  
Lois Gerstenmaier  
Natalie Griffin-Kinney  
Deidre A. Hanlon  
Melissa Knauer  
Mary Jo Kormushoff, Realtor,  
and the Welcome Home Team  
Emily Marks  
Jennifer McDonald  
Annie McFadden  
Kristy Myers  
NRDesign - Nicole Dumont  
Jillian Olsen  
Linda F. R. Omobien  
Pamela O'Neill  
Jacqui Ricchiuti  
Jennifer Rogers-Dagnall  
Carolyn Schmidlin  
Sara Schroedl  
Carrie Sellers  
The Social Dept. LLC,  
Christy Taray  
Colleen Tate  
Jennifer Toth  
Robert Emmett Wilson  
Jillian Wimer  
Ashley Woodford-Lawson  
Colleen Zografakis

**St. Gabriel Fund**

Anonymous  
Karen M. Frey

**St. Sebastian School Fund, #WeGiveCatholic "The Playground Project"**

Mark and Becky Adamczyk  
Janice Alpeter  
Anonymous (40)  
Annette K. Bailey  
Edward Balaun  
Chris and Melissa Bauer  
Andrew Bebesi  
Brenda Pier Beck  
Anthony and Emily Boarman  
Kaitlyn Bradley  
Max and Rachael Brady  
Chris and Rachel Brinkley  
William Broadhurst  
Christopher and Maureen Brown

# The Chesterton Academy of Akron Wonder Scholarship

Initiated in 2025, The Chesterton Academy of Akron Wonder Scholarship provides tuition assistance to a parishioner and/or graduate of St. Sebastian Parish School who will attend Chesterton Academy of Akron for high school. The scholarship is inspired by the G.K. Chesterton quote: "I would maintain that thanks are the highest form of thought, and that gratitude is happiness doubled by wonder." This one-time \$1,000 scholarship toward freshman year tuition was established by the Chesterton Academy School Board, pictured below: (front) Terry Tolson, Rocco G. Galizio, Christine Ortiz, (back) Rev. Matthew Pfeiffer, Ivan Ortiz, Michael Saltis.

To learn more about donating to The Chesterton Academy of Akron Wonder Scholarship Fund, please contact Kathy Holaday at the Foundation (330-836-2233 x113, holadayk@stsebastian.org) or visit the Foundation's Funds and Endowments web page: [stsebastian.org/foundation/funds-and-endowments](http://stsebastian.org/foundation/funds-and-endowments).



Robert and Joan Brownfield  
Ken and Peggy Contrera  
Tracie and Jerry D'Antonio  
Daniel Deckler and Susan Clark  
Ann and John Fairweather  
Emily Fernandez  
Thomas and Michelle Freeman  
Theresa and James Gadomski  
Frederick George  
Michael and Francesca Gerbick  
Jack and Erica Gerstenmaier  
Lois and John Gerstenmaier  
Will and Bernadette Gibson  
Thomas J. Grode  
Jamie Hale

Diane and Thomas Haller  
Daniel and Laura Haramis  
Brian Hohenadel  
Katheen and Mark Holaday  
The Hubbard Family  
Mike and Michelle Huber  
Elizabeth Indriolo  
Briana Johnson  
Gary and Beth Johnson  
Tim and Carole Johnson  
Tom and Katy Karg  
Kurt and Laura Karhoff  
Margaret and John Kastelic  
Mary Anne and Albert Kim  
Ronald and Margaret Klamert

**St. Sebastian School Fund,  
#WeGiveCatholic "The  
Playground Project" cont'd.**

Melissa and Tom Knauer  
Tim and Ellen Koehler  
Joy Wiesheier Kraft  
Ryan and Jill Lang  
Larry and Meg Lee  
Jim and Julie Lucko  
Tim and Emily Marks  
Paul and Linda McCann  
Anita Meeker  
Eileen Moats  
Rachel Musgrave  
John Najeway  
David and Kristina Newyear  
Nick and Monique Nordberg  
Robin and Marian Olsen  
Patrick and Pamela O'Neill  
Molly O'Reilly Phelps

Marjorie and Jeffery Parrish  
Michael and Hannah Paulin  
Jeffery and Mikaela Pelton  
Paul and Kathleen Perry  
Andrew and Katie Pirie  
Rodger and Patty Post  
Jeff and Lisa Quinn  
Christopher and Mary Randolph  
Betty Regan  
Lucia and Michael Regan  
Keith and Shannon Rousseau  
Nancy Ryland  
The Savitski Family  
Kelly and Thomas Seikel  
Frances Sharp  
Josh and Kim Skerl  
Marcy Smith  
Milissa Smith  
Kyle and Weston Sokol  
Robert Sosenko

Marianne Spiros  
Mary St. Clair  
Susan Teagarden  
Mr. and Mrs. Louis Trenta  
Heidi and Aaron Tripp  
Manuela Turner  
Ben and Pam Urdiales  
David\* and Lois Weis  
John and Susan Wilgus  
Robert E. Williams II  
Katy and Jon Wills  
Andrew and Jillian Wimer  
Elliott and Ashley Woolf  
James and Elizabeth Young  
Carole Zachardy  
Richard and Ann Zsembik

**Jay and Marilyn Stitz  
Scholarship Endowment**  
Jay and Marilyn Stitz Fund

**Terrier Family Scholarship Fund**

Anonymous  
Thomas\* and Laurie Burke

**John L. and Nellie A. Tormey  
Rectory Restoration Fund**

James N. Tormey  
Thomas A. Tormey

**John A. Trecaso Scholarship  
Endowment**

John S. Trecaso  
Marianne J. Trecaso

**Zwisler Hall Plaza Fund-  
Commemorative Bricks/  
Benches**

Linda Davis  
Social Ministry

**UNRESTRICTED GIFTS**

Gifts to the Unrestricted Fund are used for the greatest needs of the parish.

Patricia Abdenour  
Judge John R. Adams  
Ernesto and Christine Alessio  
Janice Alpeter  
Thomas J. Amer  
Anonymous (10)  
Timothy App\*  
Tim Aylward  
John and Karen Bader Family  
Fund  
Edward Balaun  
Tom and Chris Baugh  
Martin Baumgardner  
The Beatty Family  
Mike and Brenda Beck  
Jennifer Waters Becker  
Max and Josellen Bedell  
Kathy Coyne Bergh  
Brigid Beringer  
Nancy Beringer  
Janet and Francis Berkemeier  
Adam L. Bernard  
Stanley and Lisa Bernat  
Allie and Alec Bianchi  
Thomas and Jeanette Boggs  
Ray Boshara

The Estate of Ramona M. Botzum  
David and Martha Bremer  
Mary Alice Hardt Brosseau  
Teresa Redle Brostowitz  
Stephen and Catherine Buschko  
Albert Caliri  
Michael and Danielle Cianciola  
Janet, Jimmy and Julie Ciotola  
Anne Lynett Clark  
Thomas and Patricia Cleary  
Mark and Susan Codding  
Laura Jean Conway  
Jim and Peggy Costigan  
Jacob and Sarah Coulter  
Edward Dannemiller  
Larry and Kathy Dannemiller  
Tracie and Jerry D'Antonio  
Dr. and Mrs. Gregory Davis  
Carol Whitehurst Deeser  
Nicholas and Monica DelMedico  
Timothy and Jennifer DelMedico  
Marian and Jim DeVoe  
Robert and Cathy Duncan  
Anne E. Dyer  
Liam Eitman  
Ronald and Margaret Elsner



Sharon Evans  
Chaker J. Fadel  
Richard and Kay Fanelly  
First Energy Foundation  
David and Patricia Fitzgibbons

Dewey and Brendan Ford Family  
Fund  
Duane and Judy Fox  
Lawrence and Mary Beth Furman  
Bernie and Kim Garner

Frederick George  
 Tony and Tricia Gerak  
 Jack and Erica Gerstenmaier  
 Lois and John Gerstenmaier  
 Gerald J. Glinsek  
 Keith and Noreen Goble  
 The H. E. Graves, Jr. Family  
 Foundation  
 The Kevin & Cindy Hackett Donor  
 Fund  
 Daniel and Laura Haramis  
 Joe Harp  
 Jim and Jane Harris  
 Katherine Hatton and Richard  
 Bilotti Fund of the Princeton  
 Area Community Foundation  
 Dan and Laurie Hayes  
 Joe Henninger  
 Michael and Kristene  
 Hergenrother  
 Paul and Dianne Hergenrother  
 William and Anne Hergenrother  
 John Hickey  
 Kathleen and Mark Holaday  
 Rodney and Barbara Houck  
 Michael and Michelle Huber  
 Terence and Joan Hughes  
 Gabe Kasper  
 Paul Kearnes  
 Ronald and Margaret Klamert  
 Jim and Sally Klein  
 Donald Kline  
 David and Nancy Koly  
 Michele Metz Kordella  
 Sue Dessecker Korosa '64  
 Maureen and Greg Kudlac  
 Dr. Cathleen Labate  
 Denise Labut  
 Charles and Sheryl Lamb  
 Frank J. LaRose  
 Michael and Debra Lavelle  
 Patrick and Linda Leary  
 Dan and Amanda Leffler  
 Michael and Christine LeMonier  
 Margaret Lombardi  
 Edward Longville  
 John and Alice Luse  
 John and Michele Lynch  
 Michael Magee  
 Bob and Debbie Mancino  
 David and Sherry Marshall  
 Patrick Mattes  
 Jim Maurer  
 Peter Maynard  
 Dennis McAleese

Paul and Linda McCann  
 James McCready  
 Bill and Lorraine McCue  
 Dave and Terry McCulley  
 Elizabeth A. McGrath  
 Mike and Ginny McGuckin  
 Patricia McLaurin  
 Anita Meeker  
 Lynette and Abbey Monaghan  
 Virginia Morabito  
 Michael E. and Suzanne J.  
 Murphy  
 Paul R. Murrow  
 Gregory Naifeh  
 Michael and Judy Neman  
 Jerry and Judy Noblit  
 Michael and Pola Ochsenhirt  
 Sean and Nancy O'Connor  
 William C. Pepple and  
 Dr. Nancy L. Ryland  
 Charles A. and Theresa Peter  
 Jim and Barb (Mancino) Petruccio  
 Molly O'Reilly Phelps  
 Elizabeth Pinkerton  
 Ed and Mary Pullekins  
 Robert and Sharon\* Rader  
 Christopher and Mary Randolph  
 Tracy and Michael Reiss  
 The Estate of Mary Beth  
 Reymann-Conroy  
 Riot Games Inc  
 Al and Phyllis Rose  
 Gregory and Sarah Rossi  
 John and Nadine Rote  
 Bernard P. Rothermel, Jr.  
 Theodore and Sandra Sadar  
 Charles and Susanne Sassano  
 Basil J. and Anne L. Scafidi  
 Charitable Trust  
 Timothy Scanlon  
 Julian Severyn  
 John and Susan Showlin  
 Dave and Paula Singleton  
 Christopher and Megan Slattery  
 Mike and Julie Traverse Smerdel  
 Robert Sosenko  
 Ken and Sally Stenger  
 Stifel Nicolaus, Jason Pepe Team  
 Michael R. Stiller  
 Michael W. Stiller  
 William Stiller  
 Summa Health System  
 Medical Staff  
 Michael and Deborah Taschner  
 Susan Teagarden

# Your Gift Makes an Impact!

The St. Sebastian Parish Foundation relies on the generosity of our community to help secure a stable future for our parish for generations. Thanks to generous gifts to the Foundation, we are able to help ensure that the traditions of St. Sebastian Parish continue for many years to come. As you consider your annual charitable giving, please consider a donation to the St. Sebastian Parish Foundation. Your donation will make a real difference, with a measurable impact on our faith community. No gift is too big or too small, and all donations are tax deductible.

## Gift Methods

- Cash or check (payable to St. Sebastian Parish Foundation)
- Donor Advised Funds and Charitable Giving Trusts
- Online: [stsebastian.org/foundation/donate](http://stsebastian.org/foundation/donate)
- Transfer of stock holdings or retirement plan
- Choosing the Foundation as a beneficiary of a will or IRA

## Gift Designations

- To support the Unrestricted Fund for the parish's greatest current need
- To support any of the nearly 90 funds and endowments

## Does Your Employer Have a Matching Gift Program?

Matching gifts are a wonderful way to support the St. Sebastian Parish Foundation! Many companies have a matching gift program that can enable you to double or even triple the value of your donation at no cost to you. Check with your employer, or contact Kathy Holaday at the Foundation (330-836-2233 x113 or [holadayk@stsebastian.org](mailto:holadayk@stsebastian.org)) for more information.

St. Sebastian Parish Foundation  
 476 Mull Avenue • Akron, OH 44320  
 330-836-2233 x113 • [foundation@stsebastian.org](mailto:foundation@stsebastian.org)

Mildred Telford  
 Teresa Kloss Thompson  
 Ann M. Towell  
 Ann Traverse  
 Bonnie Trickett  
 Bob Ulrich  
 Ben and Pam Urdiales  
 Sophie and Bob Veillette  
 Mark and Patricia Waickman  
 Brian and Sharon Walsh

Mary Kathryn Walsh  
 Bill and Peggy Wellemeyer  
 Gretchen Wellemeyer  
 Mark and Colleen Wernig  
 Susan Flanagan Wervey  
 Deanna White-Hebert 1955  
 Donald Williams  
 Virginia Yocono  
 Susan D. Zachardy  
 Dennis and Kathleen Zant

## PARISH SCHOOL SCHOLARSHIPS

Every year, the St. Sebastian Parish Foundation hosts the Foundation Scholarship Mass to honor the students who receive scholarships and acknowledge the generosity of our scholarship donors. In 2025, the Mass was held on March 27, when a total of 58 scholarships worth \$47,300 were awarded to students for the 2025-26 school year. These scholarships are offered annually by four parish entities as well as the St. Sebastian Parish Foundation. The Foundation alone awarded 51 scholarships worth \$41,800. The Foundation is deeply thankful for the many wonderful donors who have established and supported these scholarships.

If your family would like to start your own scholarship or contribute to an existing fund to support St. Sebastian Parish School students, please contact Kathy Holaday at the Foundation (330-836-2233 x113, holadayk@stsebastian.org) or visit [www.stsebastian.org/foundation/scholarships](http://www.stsebastian.org/foundation/scholarships). For a complete list of Foundation Endowments, Funds and Scholarships that directly benefit our church and school, please visit [www.stsebastian.org/foundation/funds-and-endowments](http://www.stsebastian.org/foundation/funds-and-endowments).



## COME VISIT ST. SEBASTIAN!

### CAMPUS TOURS

We are always happy to provide informal tours of our school and church for our alumni, parishioners, family and friends! Please contact Kathy Holaday (330-836-2233 x113 or [foundation@stsebastian.org](mailto:foundation@stsebastian.org)) to schedule a tour at a convenient time for you and/or your group.

### VIRTUAL TOUR

The St. Sebastian Parish Foundation created a virtual tour of our campus, with special highlights of the school, as part of the Foundation's 50th anniversary celebrations in 2021. To view, please visit [www.stsebastian.org/foundation](http://www.stsebastian.org/foundation) and click on "Foundation's 50th Anniversary Virtual Tour."

## STAY CONNECTED

### YouTube:

The St. Sebastian Parish channel on YouTube not only livestreams Masses but also features videos that range from school processions in 1937, to First Communion in the 1960s, to recent school tours offered by the students! Visit [www.youtube.com/@StSebastianParish/videos](http://www.youtube.com/@StSebastianParish/videos).

### Facebook and Instagram:

The school and parish have active social media pages to help you stay connected and informed. Check them out!

**CHURCH** Facebook: St. Sebastian Parish  
Instagram: @st.sebastianparish

**SCHOOL** Facebook: St. Sebastian Parish School  
Instagram: @st.sebastianschool

St. Sebastian Parish School

**ALUMNI**  
ASSOCIATION

The St. Sebastian Parish Foundation is the home of the St. Sebastian Parish School Alumni Association. The Foundation maintains the alumni database, publishes the Alumni Arrow newsletter three times a year, and hosts the annual Alumni Mass, which is held on the Saturday after Thanksgiving. The Foundation also assists reunion planners by providing mailing lists for classmates, and when there is interest, tours of our parish school for reunion groups.

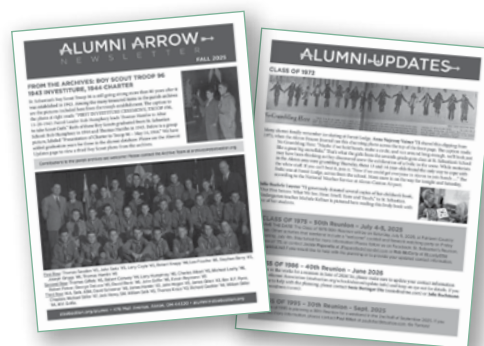

## VISIT THE ALUMNI WEBSITE

The St. Sebastian Parish School alumni website ([www.stsebastian.org/school/alumni](http://www.stsebastian.org/school/alumni)) is a great place for alumni to update their current contact information so they can stay informed on reunions and the latest news from their alma mater. Alumni may also share personal news or memories of their school days through the website. We love to hear from our alumni!

# THANK YOU

Gifts in memory, honor and celebration

## GIFTS IN MEMORY

---

### **In memory of 1958 Classmates**

Jim Maurer  
Dennis McAleese

### **In memory of 1975 Classmates**

Denise Labut

### **In memory of Terry Ajamie**

Lawrence and Mary Beth Furman

### **In memory of Barbara Singleton Alesch**

Christine Boyce  
Kendra Jones  
Barbara Carroll LaRose  
Domenico and Diane Lazzzerini  
Tracy and Jim Legner  
Anne Miller  
Sue and Bo Roberts  
Bill and Peggy Wellemeyer

### **In memory of Gary Arman**

Pamela Arman  
Jim and Jane Harris

### **In memory of Kathleen E. Bachmann**

Brigid Beringer

### **In memory of John C. Beringer, Sr.**

Brian and Sharon Walsh

### **In memory of Stanley and Irene Bernat**

Stanley and Lisa Bernat

### **In memory of Ernest Bianchi**

Allie and Alec Bianchi

### **In memory of Ramona Botzum**

Nancy Beringer  
David and Martha Bremer  
Ann M. Towell

### **In memory of Victor E. Buehrle, Jr.**

Kathleen J. Buehrle  
Rosemary and Frank Floccari  
Jeannie and Jubi Hillery

### **In memory of Thomas Burke**

Anonymous  
Ginny Bowers  
David and Teresa Burke  
Laurie H. Burke  
Catherine Conway  
Charlie and Mary Crowley  
Nancy and Ben Harmon  
Brian and Jeanne Heard  
Richard and Glenda Heard  
Ann Huesken  
Rich and Mary Ellen Crowley  
Huesken  
William Huesken and  
Kaylee Charlton  
Sally Jochimsen  
Mary Lee Mattis  
Jane May  
Corinne Reeves  
Gus and Belinda Rubio

### **In memory of Stephen, Patricia, Karen and Tom Buschko**

Stephen and Catherine Buschko

### **In memory of Fr. Charles L. Byrider**

Katherine Hatton and Richard  
Bilotti Fund of the Princeton  
Area Community Foundation

### **In memory of Will Cardina**

Frank C. Comunale  
Robin and Marian Olsen

### **In memory of Frank Cleary, Class of 1966**

Cathleen Cleary Hawes

### **In memory of Robert E. Conway**

Catherine Conway

### **In memory of Elizabeth Balaun Coughlin**

Edward Balaun

### **In memory of Chuck Cypher**

Allie and Alec Bianchi

### **In memory of Tom, Evelyn and Jere Dannemiller**

Larry and Kathy Dannemiller

### **In memory of Jacquelyn M. DelMedico**

Judge John R. Adams  
Thomas J. Amer  
Tom and Chris Baugh  
The Beatty Family  
Mike and Brenda Beck  
Janet and Francis Berkemeier  
Janet, Jimmy and Julie Ciotola  
Anne Lynett Clark  
Thomas and Patricia Cleary  
Nicholas and Monica DelMedico  
Timothy and Jennifer DelMedico  
Lois and John Gerstenmaier  
Daniel and Laura Haramis  
Michael and Michelle Huber  
Jim and Sally Klein  
David and Nancy Koly  
Margaret Lombardi  
John and Michele Lynch  
Gregory Naifeh  
Sean and Nancy O'Connor  
Mike and Julie Traverse Smerdel  
Ann Traverse  
Sophie and Bob Veillette  
Mark and Patricia Waickman  
Mark and Colleen Wernig

### **In memory of Reynold "Renie" Desman, Class of 1958**

Jim Maurer

### **In memory of Lisa Hunt Dietrich**

Jack and Erica Gerstenmaier  
Lois and John Gerstenmaier  
Robin and Marian Olsen

### **In memory of John Dotson**

Anonymous

### **In memory of David G. Dyer**

Anne E. Dyer

### **In memory of Jim Fenwick**

Patrick Mattes

### **In memory of Denise Maroon Finley**

Chuck Maroon

### **In memory of Susan M. Foley, Class of 1973**

Patricia Abdenour

### **In memory of Philip F. George, Sr.**

Frederick George

### **In memory of Richard J. Gross**

Fred and Jeannie King

### **In memory of Karen Sue White Guistino 1957**

Deanna White-Hebert 1955

### **In memory of Nancy Schwab Hamlin**

Bob and Martha Burgoon  
Dr. and Mrs. Ernest Estep  
Ann and John Fairweather  
Randi Forrest  
Ethel Seiberling Fox  
The Patricia and J. Harvey Graves  
Family Foundation  
Laura Hunsicker  
Jim and Sally Klein  
Joan Kramer  
Renee Kulman  
Tom and Meg Lamb  
Mr. and Mrs. Frederick May  
John and Kathleen Negrelli  
Molly and Dave Scantling  
Jane P. Schwab  
Margaret Taylor  
Ann Traverse

**In memory of Nancy Schwab Hamlin, cont'd.**

Maureen Van Duser  
Mark and Colleen Wernig  
Bradley Wojno

**In memory of Beth Mancino Hawke**

Bob and Debbie Mancino  
Jim and Barb (Mancino) Petruccio

**In memory of Eileen Hudson**

Mark and Margie Jost

**In memory of Joseph E. Kastelic, MD**

Anita Meeker

**In memory of Carol Samels Kastner**

Joy Wiesheier Kraft

**In memory of Andrew Kirkland**

Anonymous

**In memory of Dr. Joseph L. Kloss**

Joe Henninger  
Stifel Nicolaus, Jason Pepe Team  
Summa Health System  
Medical Staff

**In memory of Joseph and Lina Kloss**

Teresa Kloss Thompson

**In memory of Gary Kordella**

Michele Metz Kordella

**In memory of Jeannette Scala Krause**

Joy Wiesheier Kraft  
Mary and George Skalkos  
Susan D. Zachardy

**In memory of Thomas and Jeanne LaRose**

Brian and Sharon Walsh

**In memory of Angelina Lobello**

Dolores Lobello DiCresce

**In memory of Joseph and Angelina Lobello**

Patricia Lobello-Lamb

**In memory of Mike Magyar**

Susan Flanagan Wervey

**In memory of Steve and Generose Marks**

Anonymous  
Frank C. Comunale  
Tricia Marks Marshel  
Mary Cay and Tom Pelot  
Michael N. Rabe Family  
Philanthropic Fund  
Heather and Barry Thoman

**In memory of Helen Hamlin Marshall**

Alan and Tari Abrams  
Michael Abrams  
The Tarang and Hirni Amin  
Family Fund  
Julia Bain\*  
Tom and Chris Baugh  
Brenda and Mike Beck  
Mark and Beverly Belgya  
Ann and John Beringer  
J. David Bourke  
John and Allison Brase  
Jeffrey Bresler  
The Broers, Browns and  
Lallathin Families  
Charles and Karen Hay Chadwick  
Mark and Cathy Clark  
Stephen A. Comunale  
James and Renee Conlon  
Richard and Anne Davidovich  
Julie Deane  
Timothy and Jennifer DelMedico  
William S. Eakins, Jr.  
Dr. and Mrs. Ernest Estep  
Richard and Colleen Farrell  
Judith Fowler  
Michael Foy and the RBC Team  
Deborah Franz  
Ruthie George  
The Patricia and J. Harvey Graves  
Family Foundation  
Robin Hardman  
Georgie Herro and Lamice Saidy  
Laura Hunsicker  
Joseph and Janis Hutchinson  
The J. M. Smucker Co.  
Patricia and Timothy Jolly  
Otto and Anne Kern  
Gail Kinzel  
Jeanette Knudsen  
Peggy Ethridge Koblenzer

David and Nancy Koly  
Robert Krautsak  
Tom and Meg Lamb  
Barbara Carroll LaRose  
Michael and Debra Lavelle  
Donna Leahy  
Wilson and Wendy Lewis - Lewis  
Landscaping & Nursery Inc.  
Allen and Donna Loomis  
Mary and Jim Lyons  
Chester Marshall  
Brian and Stephanie McCarty  
Mr. and Mrs. Seward Prosser  
Mellon  
Steve and Laurice Moore  
Omar Nemer and Bahar  
Moftakhar  
Erik and Angela Niermeyer  
Robin and Marian Olsen  
The Preferred Legacy National  
Trust Bank  
Joshua Rivard  
Anne Hardman Roddy  
Richard and Alita Rogers  
Alan Scharfstein  
David Schrader  
Margot and Ron Schroder  
Elizabeth Sheeler  
John Shulan  
Jillian Snoke  
Glen Stalcup, Jr.  
Jodi Taylor  
Judith Jones Thomas  
Alexandra Walker  
Robert and Fleur Warther  
William and Kathryn Welsh  
Pamela and Frank\* Wharton  
Ed and Mandy Williams  
Bradley Wojno  
Mary Wojno  
Christine Yuhasz

**In memory of Cletus and Kathryn McGuckin**

Richard McGuckin

**In memory of Mary Metz**

Michele Metz Kordella

**In memory of Frank and Katherine Meyo**

Frank C. Comunale

**In memory of Bill Monaghan**

Lynette and Abbey Monaghan

**In memory of Patrick E. Morabito**

Virginia Morabito

**In memory of The Ochsenhirt Family**

Bonnie Trickett

**In memory of Mike Patnode, Class of 1958**

Jim Maurer

**In memory of Patricia Rose Patrino**

Virginia Yocono

**In memory of Michael J. Pavick**

Nancy Ryland

**In memory of Deacon Terry Peacock**

Frank C. Comunale  
Al and Phyllis Rose  
John and Colleen Zografakis

**In memory of Ann Pinkerton**

Elizabeth Pinkerton

**In memory of Marilyn Poggiali**

Susan Teagarden

**In memory of Michele Rader**

Robert and Sharon\* Rader

**In memory of Jennifer Rohr**

Lois and John Gerstenmaier  
Ronald and Margaret Klamert  
Sophie and Bob Veillette

**In memory of Bernard P. and Florence M. Rothermel**

Bernard P. Rothermel, Jr.

**In memory of Sally, Kathryn and Arthur Scarpitti**

Ronald Scarpitti

**In memory of Christine Schlegal**

Ben and Pam Urdiales

**In memory of Barbara Sheeks**

Donn I. Cramblette

**In memory of James, Larry,  
Barbara and Sandra Singleton**  
Dave and Paula Singleton

**In memory of Lawrence  
Singleton**  
Anonymous  
Dr. and Mrs. Gregory Davis  
Barbara Carroll LaRose  
Mark and Patricia Waickman

**In memory of Ruth Stiller**  
Michael R. Stiller

**In memory of Raymond Stone**  
Lawrence and Mary Beth Furman

**In memory of Nancy Ulrich**  
Janet Ciotola  
David\* and Lois Weis

**In memory of Lina Urdiales**  
Ben and Pam Urdiales

**In memory of Karen Coyne  
Volpe**  
Kathy Coyne Bergh

**In memory of Lawrence Walsh**  
Anonymous  
Frank C. Comunale  
Joe Harp  
Patrick and Linda Leary

Mike and Ginny McGuckin  
John and Susan Shovlin  
Brian and Sharon Walsh  
Dennis and Kathleen Zant

**In memory of Rita Durosko  
Walsh**  
Duane and Judy Fox  
Peter Maynard  
Jerry and Judy Noblit

**In memory of Kandi Waters**  
Rodney and Barbara Houck

**In memory of Ruby J. Williams**  
Donald Williams

**In memory of Yvonne and Zuker  
Zehenni**  
Kathleen and Mark Holaday

**In memory of Charles Zeno**  
Patrick Mattes

**In memory of Marita Zupke**  
Thomas and Jeanette Boggs  
Frank C. Comunale  
Robert and Cathy Duncan  
Dan and Laurie Hayes

## GIFTS IN CELEBRATION

**In celebration of Mike Beck's  
Birthday**  
Milo and Mary Lou Chelovitz  
Patrick and Pamela O'Neill  
Jim Redmond

**In celebration of Dave and  
Terry McCulley's Convalidation  
of Marriage**  
Dave and Terry McCulley

**In celebration of Lois and  
John Gerstenmaier's 50th  
Wedding Anniversary**  
Patrick and Pamela O'Neill

## GIFTS IN HONOR

**In honor of Mike and Pat Bedell**  
Max and Josellen Bedell

**In honor of Jeff Conway**  
Laura Jean Conway

**In honor of The Class of 1960**  
Robert Floyd

**In honor of Rosemarie George**  
Frederick George

**In honor of The Class of 1962**  
Joy Wiesheier Kraft

**In honor of Midge and Ralph  
Maher**  
John and Alice Luse

**In honor of The Class of 1964**  
Sue Dessecker Korosa '64

**In honor of Karen Spangler**  
Anita Meeker

\* Deceased

## Annual Appeal

Thank you to everyone who made a gift to the St. Sebastian Parish Foundation in response to our Annual Appeal! Every year we are blessed to have the support of parishioners, school families, alumni, and friends of the parish and school during the holidays. Gifts to the Annual Appeal are a critical source of funding for the Foundation's Unrestricted Fund, which provides support for the areas of greatest need in the parish.

The 2025 Annual Appeal card featured a stained-glass window, part of a set of three windows located in the server's sacristy, each of which depicts different duties of altar servers. This window includes images of the processional cross along with the two processional candles that flank the cross in procession, giving it honor. The window provides visual focus and inspiration to altar servers and reminds them that they are not just performing a task, they are helping to "honor and serve" God and his people.

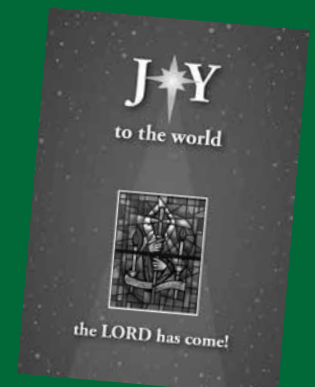

# CAPITAL IMPROVEMENTS

## 1 Rectory Steps

A three-step section on one side of the rectory steps was in dire need of repair. The sandstone steps were removed, reset, and the joints and treads were re-sealed/caulked. The Foundation paid for this project with funds from The John L. and Nellie A. Tormey Rectory Restoration Fund.

## 2 Church Steps/Plaza

The church steps and front plaza also received masonry repairs in several areas. Workers caulked the granite pavers and treads that extend past the building at the front entrance. The limestone jambs at both sides of the left entrance were patched and caulked. Workers reset six granite pavers and three small stone sections that had shifted out of place from the freeze and thaw process. Repairs were also completed to the railing grout, the mortar in the jambs at both sides of the main entrance, and the stone sections in the ramp area on both sides of the church. These repairs were paid from the Foundation's Church Improvement Fund.

## 3 School Windows

Every window in the school building was repaired or restored using funds from the Foundation's St. Sebastian School Fund. The window balances were failing in the majority of the window sashes, making them difficult and unsafe to operate. Many of the windows did not have screens, so teachers were unable to open them for fresh air. In total, 255 school windows were repaired/restored, and 138 screens were installed. This work will extend the life of the windows as well as make them more energy-efficient and safer to operate.

## 4 Additional Upgrades/Repairs

The Foundation funded several additional capital projects, including the purchase of a tankless water heater for the school, new lighting in sacristy/altar area, and a new drinking fountain/bottle refill station for Byrider Hall. Repair and cleaning work included plaster repairs in the church from recurring water damage; tuck pointing and power cleaning for the exterior of Zwiser Hall; roof/ceiling repairs for the junior high wing; and power cleaning for the church exterior, including the soaring bell tower and church façade. In October, a new boiler conductivity auto blowdown system was installed in the school. This automated system is more energy efficient and requires less maintenance than the old manual system. The Foundation paid for these projects with funds from The St. Sebastian School Fund, The Church Improvement Fund, and The Byrider Hall Improvement Fund.

## 5 We Give Catholic/Giving Tuesday

### 2024: Creating Welcoming Spaces

Funds raised from the 2024 #weGiveCatholic effort, called "Creating Welcoming Spaces," were dedicated to improving several areas in our church entrance. More than 130 people donated \$27,047 toward this effort, which funded upgrades to both the bride's room and the family quiet room. The bride's room received new furniture, décor, paint, and lighting as well as a complete renovation of the adjoining restroom with fresh paint, a new mirror, new vanity, and updated lighting. The family quiet room received fresh paint and new lighting, and the adjoining restroom was also completely renovated with a new vanity, updated lighting, and fresh paint. Funds also provided for the installation of speakers in the church narthex, the bride's room, and the usher's room, enabling churchgoers to better follow along with Masses and events in these spaces. Thanks to the generous response of our donors, the Foundation was also able to pay for upgrades to other high-use areas of the church: the basement meeting room was painted and new carpet was installed, and both restrooms and the hallways in the basement received fresh paint and updated lighting. Thank you to everyone who helped make these spaces in our church more welcoming and functional!

### 2025: The Playground Project

#### #WEGIVECATHOLIC 2025 RAISES \$11,331

Thank you to everyone who supported the 2025 #weGiveCatholic effort on Dec. 2, 2025! We raised \$11,331 from 140 donors for "The Playground Project: Growing in Mind, Body and Spirit." All proceeds will go toward the purchase of new playground equipment to replace the well-used structures that have been in place for over 20 years. Don't worry, the iconic big tire will remain! Additional funding for the Playground Project will come from the paddle raise at the 2026 St. Sebastian Spectacular, the school's largest annual fundraiser. The Playground Project is scheduled to be completed in 2026, and we look forward to sharing pictures with you in the next annual report!





# St. Sebastian Parish

476 MULL AVENUE + AKRON, OHIO 44320-1299



NON-PROFIT  
U.S. POSTAGE  
PAID  
AKRON OH  
PERMIT NO. 286



## ST. SEBASTIAN PARISH FOUNDATION MISSION STATEMENT

To help bring Christ to the world by acting as faithful stewards, to build and manage funds for long term growth and to provide financial support for the religious, educational and capital activities of St. Sebastian Parish for current and future generations.

PHONE 330-836-2233 x113

WWW.STSEBASTIAN.ORG/FOUNDATION

EMAIL [foundation@stsebastian.org](mailto:foundation@stsebastian.org)